

**BAYPORT SOUTH
BUSINESS PARK
BUILDING V**

187,983 SF UNDER CONSTRUCTION
CLASS A CROSS-DOCK FACILITY
Q2 2022 DELIVERY
PASADENA, TEXAS



Leasing by:



Jones Lang LaSalle Brokerage, Inc.

RICHARD QUARLES, SIOR
richard.quarles@am.jll.com
+1 713 888 4019

JOE BERWICK
joseph.berwick@am.jll.com
+1 713 425 5842

ELIZA KLEIN
eliza.klein@am.jll.com
+1 713 425 1816

A development by:



**JOHNSON
DEVELOPMENT
ASSOCIATES, INC.**

Part of TheJohnsonGroup

Development Specifications:

DEVELOPMENT SPECIFICATIONS & FEATURES

- Building size: ±187,983
- Office: ±1,800 SF Spec Office
- Building Configuration: Cross Dock
- Clear height: 32'
- ESFR Sprinkler System
- Dock doors: (51) 9'x10'
- Drive in doors: (1) 14'x16' drive in door with ramp included; additional available
- Truck Court Depth: 130'
- Speed Bay Depth: 65'
- Typical Column Spacing: 54'x53'
- Dock Levelers: 28 mechanical levelers with 40,000 lbs capacity (Serco WS800)
- Off Dock Trailer Spaces: 12
- Parking: ±122 auto spaces
- Warehouse lighting: 20' FC LED
- TPO membrane roof

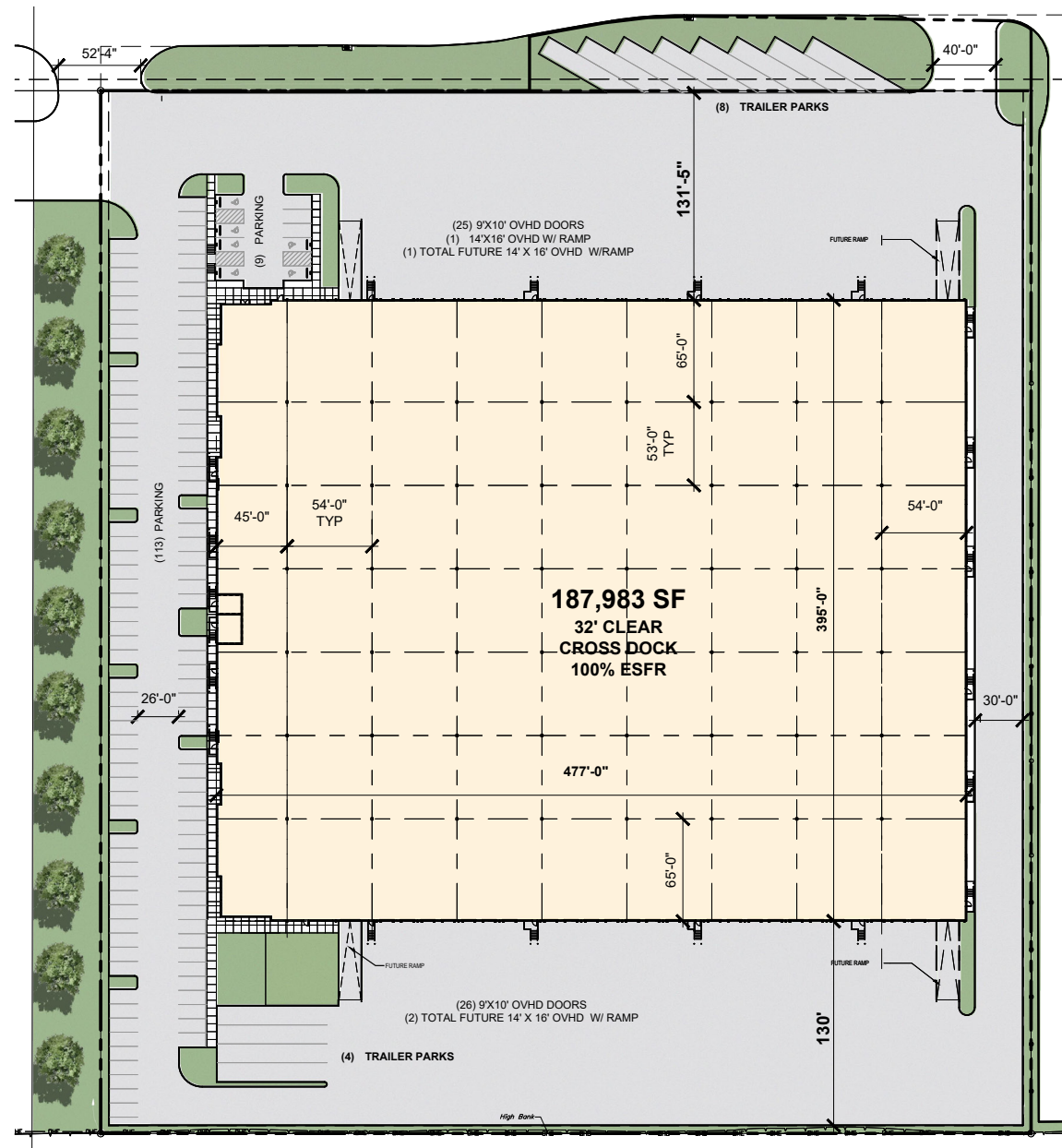

STRATEGIC PORT LOCATION

The Property is strategically located within Houston's port submarket only 3 miles from Bayport Terminal and 8 miles from Barbours Cut.

VIA MAJOR HIGHWAYS

LOCATION	APPROX. MILEAGE
HWY 146	1 mile
HWY 225	3 miles
Barbours Cut	8 miles
Bayport Terminal	3 miles
Beltway 8	7 miles
I-10	14 miles
Hobby Airport	15 miles
Downtown Houston	23 miles
IAH Airport	37 miles
Austin	180 miles
San Antonio	220 miles
Dallas	260 miles

PORT HOUSTON DATA POINTS

- Port Houston receives 68% of all container loads that enter the gulf
- Refineries in Houston produce approximately 74% of all plastics resins in the US.
- Collectively the Refineries have been going through a \$60 billion expansion since 2015.

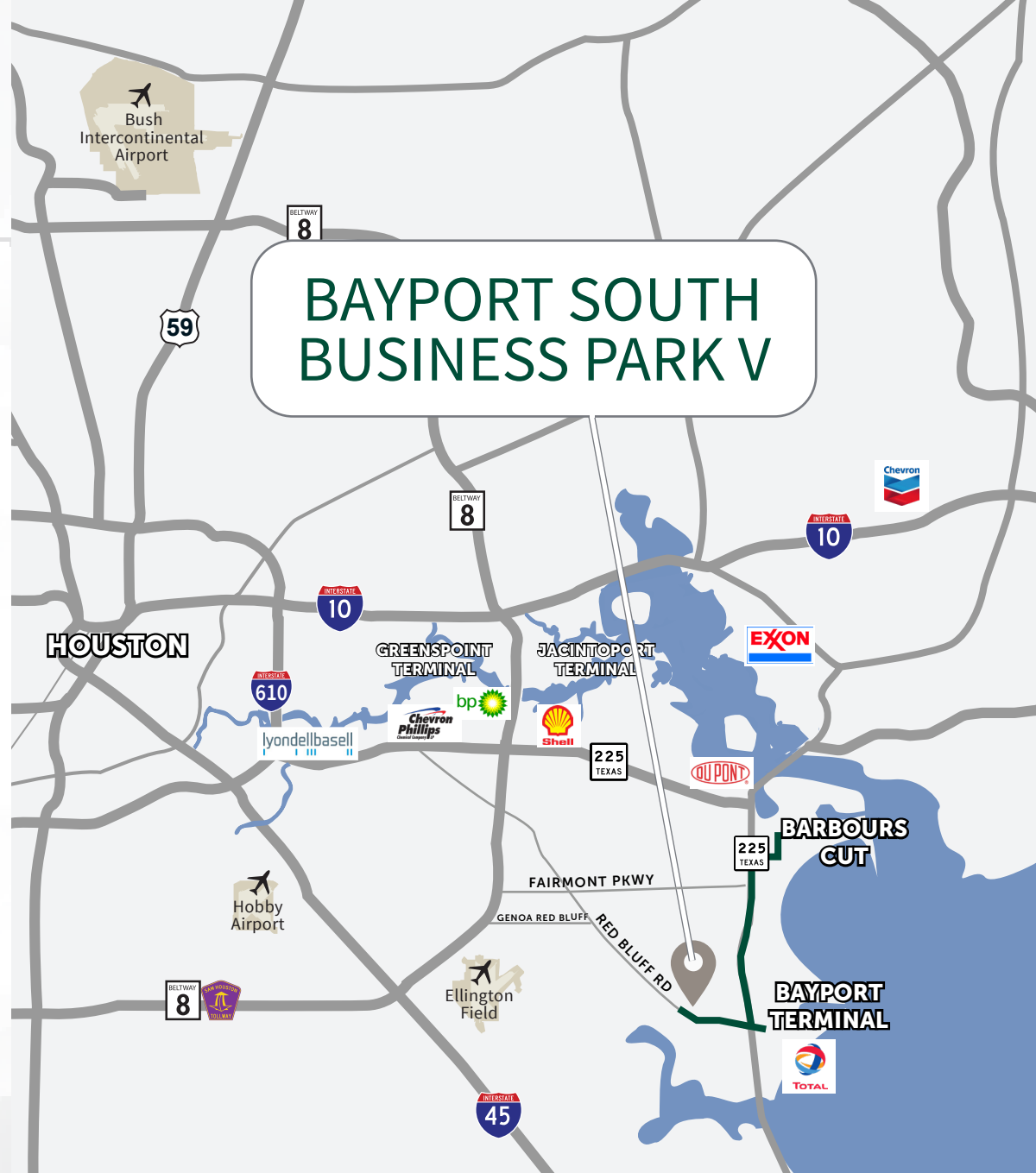

Leasing by:



RICHARD QUARLES, SIOR
 richard.quarles@am.jll.com
 +1 713 888 4019

JOE BERWICK
 joseph.berwick@am.jll.com
 +1 713 425 5842

ELIZA KLEIN
 eliza.klein@am.jll.com
 +1 713 425 1816

Although information has been obtained from sources deemed reliable, JLL does not make any guarantees, warranties or representations, express or implied, as to the completeness or accuracy as to the information contained herein. Any projections, opinions, assumptions or estimates used are for example only. There may be differences between projected and actual results, and those differences may be material. JLL does not accept any liability for any loss or damage suffered by any party resulting from reliance on this information. If the recipient of this information has signed a confidentiality agreement with JLL regarding this matter, this information is subject to the terms of that agreement. ©2021 Jones Lang LaSalle IP, Inc. All rights reserved.

LOCATION FAST FACTS

The Property is strategically located within Houston's port submarket only 3 miles from Bayport Terminal and 8 miles from Barbours Cut.

VIA MAJOR HIGHWAYS

LOCATION	APPROX. MILEAGE
HWY 146	1 mile
HWY 225	3 miles
Bayport Terminal	3 miles
Beltway 8	7 miles
Barbours Cut	8 miles
I-10	14 miles
Hobby Airport	15 miles
Downtown Houston	23 miles
IAH Airport	37 miles
Austin	180 miles
San Antonio	220 miles
Dallas	260 miles

PORT HOUSTON DATA POINTS

- Port Houston receives 68% of all container loads that enter the gulf
- Refineries in Houston produce approximately 74% of all plastics resins in the US.
- Collectively the Refineries have been going through a \$60 billion expansion since 2015.
- Balanced Trade: Shippers arrive with full containers of imported goods and depart with full containers of plastic resins

Leasing by:



RICHARD QUARLES, SIOR
richard.quarles@am.jll.com
+1 713 888 4019

JOE BERWICK
joseph.berwick@am.jll.com
+1 713 425 5842

ELIZA KLEIN
eliza.klein@am.jll.com
+1 713 425 1816

