

MESA

LOGISTICS CENTER

Up to ±358,191 SF Available Q4 2023 DELIVERY

6955 MESA DRIVE | HOUSTON, TEXAS 77028



Leasing by:



Jones Lang LaSalle Brokerage, Inc.

RICHARD QUARLES, SIOR
richard.quarles@jll.com
+1 713 888 4019

JOE BERWICK
joseph.berwick@jll.com
+1 713 425 5842

ELIZA KLEIN
eliza.klein@jll.com
+1 713 425 1816

A development by:



**JOHNSON
DEVELOPMENT
ASSOCIATES, INC.**
Part of TheJohnsonGroup

Development Specifications:

DEVELOPMENT SPECIFICATIONS & FEATURES

Building 1

- ±133,071 SF Available
- ±2,500 SF Spec Office
- Front Load Configuration
- 25' FC LED Warehouse Lighting on 15' Whips
- Drive-in Doors: (2) 14' x 16'
- Dock Doors: (18) 9' x 10'
- Trailer Parking: 29 Spaces
- Parking Spaces: 140 Spaces
- Clear Height: 32'
- Sprinkler: ESFR

Building 2

- ±225,120 SF Available
- ±2,500 SF Spec Office
- Cross Dock Configuration
- 25' FC LED Warehouse Lighting on 15' Whips
- Drive-in Doors: (4) 14' x 16'
- Dock Doors: (39) 9' x 10'
- Trailer Parking: 58 Spaces
- Car Parking: 273 Spaces
- Clear Height: 32'
- Sprinkler: ESFR

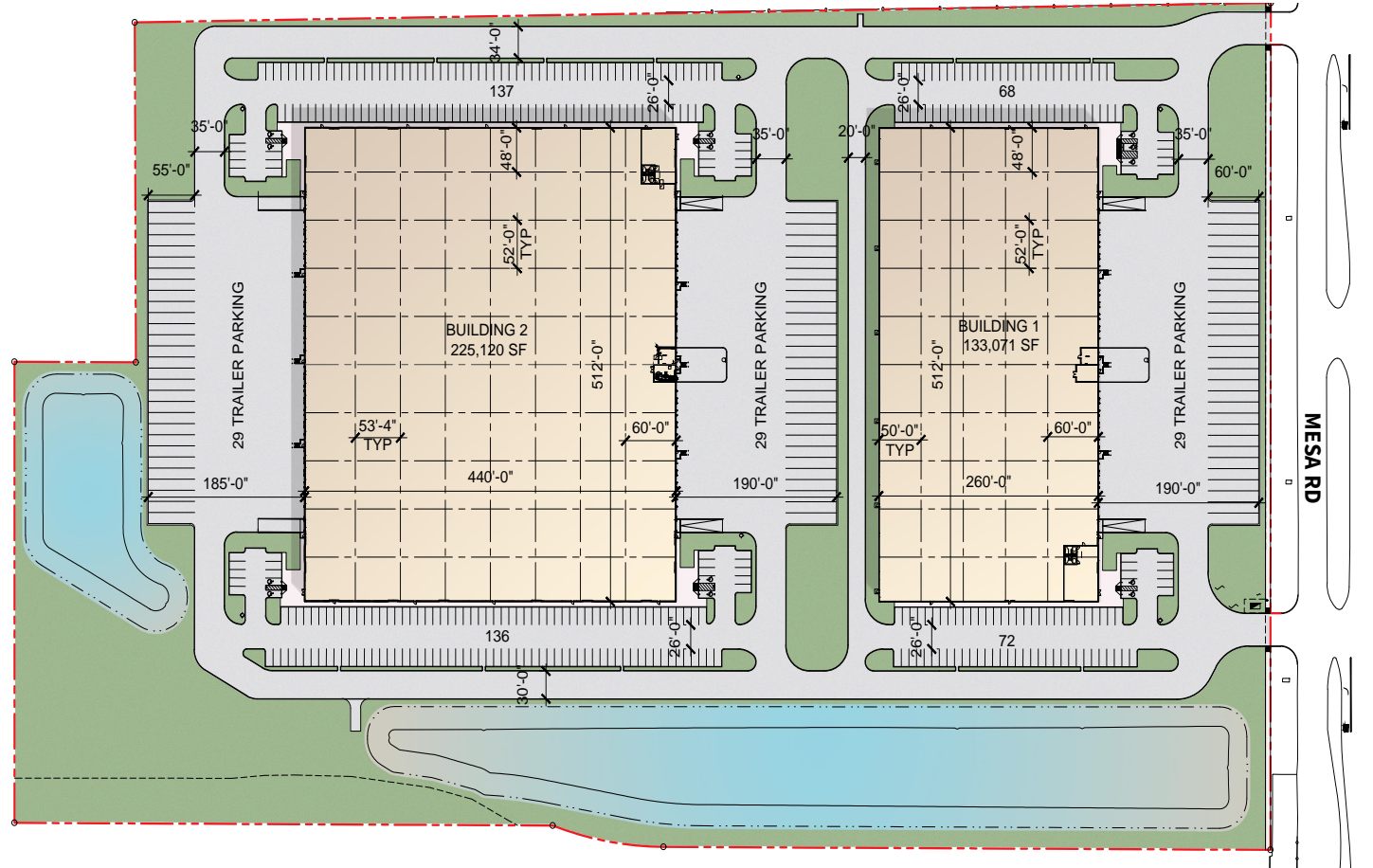

STRATEGIC LOCATION

- Served by several major highways, including I-610, Hwy 90, US-59/I-69 and the Sam Houston Tollway, providing easy access to other parts of Houston and surrounding areas
- Located in Northeast Houston, this area is witnessing ongoing development & investment, with several new residential and commercial projects underway
- Located outside of the 500 Year Floor Plan

MESA LOGISTICS CENTER

IAH
25 MIN

Highway 290
15 MIN

I-45
10 MIN

I-69
7 MIN

I-610
3 MIN

Highway 90
5 MIN

Beltway 8
5 MIN

Grand Parkway
27 MIN

CBD
11 MIN

I-10
6 MIN

610

Pasadena
13 MIN

Deer Park
17 MIN

Port of Houston
23 MIN

Baytown
23 MIN

Barbours Cut
25 MIN

Highway 146
22 MIN

Hobby Airport
13 MIN

Bayport Terminal
37 MIN

SUPERIOR REGIONAL CONNECTIVITY

Metro	Distance	Travel Time	Population
ATX	174 mi	3.0 hrs	2,30MM
SA	206 mi	3.2 hrs	2,55MM
DAL	244 mi	3.5 hrs	7,75MM

